

Project		Catalog #		Type	
Prepared by		Notes		Date	



Interactive Menu

- **Ordering Information** page 2
- **Accessory & Mounting Details** page 3
- **Installation Overview** page 4
- **Energy and Performance Data** page 5
- **Optical Distributions** page 5

Streetworks

CRTK-N Caretaker Nano

Security & Utility Luminaire

Product Certifications & Features



Product Specifications

OPTICAL

- 4 color temperature options
 - » 70CRI: 2700K, 3000K, 4000K, 5000K
 - » T2, T3, and T5 distributions
- Optional Caretaker Nano acrylic refractor
- Compatible with ANSI/NEMA open bottom refractor assembly
- Field installable snap-on shielding (single square or perimeter fence shield)

ELECTRICAL

- 120-277V; 50/60Hz
- Standard 0-10V dimming with integrated 6kV surge protection
- 10kV and 20kV surge protection options in parallel or series configurations
- -40°C to 40°C ambient temperature operating range; -40°C to 50°C ambient temperature operating range at 20-30W

PHYSICAL CHARACTERISTICS

- All aluminum construction, with die cast housing
- Raw aluminum finish; grey powder coat optional
- Tool-less access and removable driver door for easy maintenance
- Corrosion-resistant hardware
- Mounts to pipe arms 1-5/8" to 2-3/8" OD. Optional Wall/Pole Bracket allows direct mount to wood pole or wall.
- Approximate net weight without refractor (open bottom) : 4.25lbs
- EPA (without refractor) = 0.30
- EPA (with CNR refractor) = 0.36

CONTROLS

- 3-pin photocell standard; 7-pin ANSI C136.41 receptacle option
- DALI and D4i driver options available
- Optional Field Adjustable Dimming Control (FADC) module
 - » Enables manual adjustment of power consumption and lumen output. Factory preset to highest output level

- » Allows a single SKU to cover multiple field applications with manual adjustment at installation
- Fully compatible with Cooper Lighting Solutions Trellix Infrastructure UNB (Ultra Narrow Band) and cellular network lighting controls platforms.
 - » Automatic, wireless collection of luminaire performance and status data
 - » Allows asset location for inventory management of large-scale installations

COMPLIANCE

- Meets ANSI C136.31 for luminaire vibration
- Dark Sky approved for 2700K, 3000K CCT versions (when used without refractor and mounted at less than 10 degrees of tilt)
- UL Wet Location rated
- DLC and DLC Premium listed – visit www.designlights.org to confirm listed variations

WARRANTY

- Five-year limited warranty. Consult website for details. www.cooperlighting.com/legal

Dimensional Details

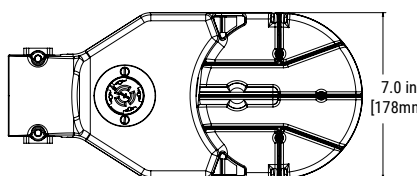

Top View

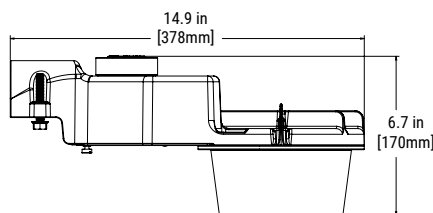

Side View With CNR

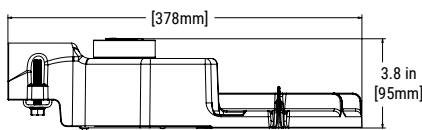

Side View

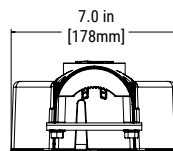

Rear View

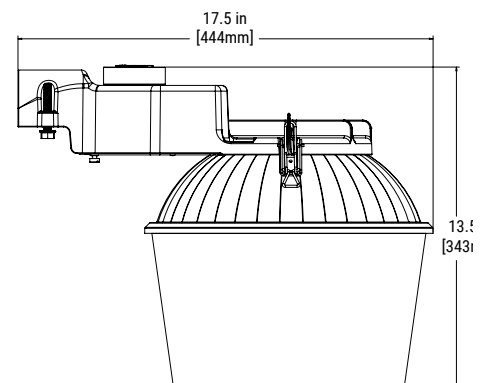

Side View With NEMA Refractor

Ordering Information

SAMPLE ORDER NUMBER: **CRTK-N-40-740-U-T2R-A**

Product Family	Wattage Bucket	Color Temperature	Voltage	Distribution	Finish
CRTK-N =Caretaker Nano BAA-CRTK-N =Caretaker Nano, Buy American Compliant TAA-CRTK-N =Caretaker Nano, Trade Agreements Compliant	20 =20W (nominal) 30 =30W (nominal) 40 =40W (nominal) 50 =50W (nominal)	727 =70CRI, 2700K 730 =70CRI, 3000K 740 =70CRI, 4000K 750 =70CRI, 5000K	U =Universal (120-277V)	T2R =Type II Roadway T3 =Type III T5R =Type V Round	A =Raw Aluminum AP =Grey
Options (Add as Suffix)	Controls		Accessories (Order Separately)		
CNR =Caretaker Nano Refractor TH =Tool-less Door Hardware 10K =Series 10kV UL 1449 Surge Protection Device 10MSP =Parallel 10kV MOV Surge Protection Device 20K =Series 20kVUL 1449 Surge Protection Device ⁴ 20MSP =Parallel 20kV MOV Surge Protection Device V =(3) 5' #14 external leads B18 =18" Wood Pole Pipe Arm B24 =24" Wood Pole Pipe Arm B30 =30" Wood Pole Pipe Arm WPBKT =Wall or Pole Mounting Bracket HA =50°C High Ambient Temperature ¹ HSS =Factory Installed House Side Shield (mounted to light square) ² Dxxxxx =DOT configuration - contact factory quotes team Uxxxxx =Utility configuration - contact factory quotes team	PR7 =NEMA 7-PIN Twistlock Photocontrol Receptacle ⁴ PSC =Photocontrol Shorting Cap included LLPC =Long Life Photocontrol included FADC =Field Adjustable Dimming Controller ³ DALI =DALI Driver ⁴ D4 =D4i driver ⁴		RMARROA5 =ANSI/NEMA Standard Refractor Assembly CNR-Caretaker Nano =Caretaker Nano Refractor LLPC =Long-life Photocontrol LLPC-F0 =Long-life Photocontrol (Fail Off) OA1226 =10kV Surge Module Replacement OA/RA1013 =Shorting Cap PBHSS =House Side Shield (single) ² PBPFS =Perimeter Fence Shield kit (4 pcs) B18PK =18" Wood Pole Pipe Arm B24PK =24" Wood Pole Pipe Arm B30PK =30" Wood Pole Pipe Arm		
NOTES: 1. Can be used for 20W and 30W only. 2. Not compatible with T5R optic. 3. Not available with 20K, PR7, DALI, or D4 options. 4. Not available with FADC option.					

House Side Shield Details

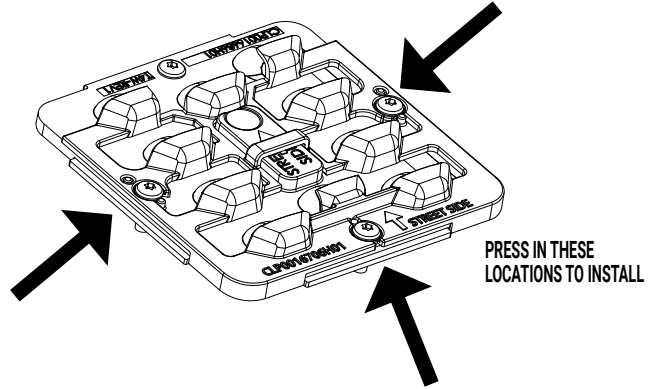
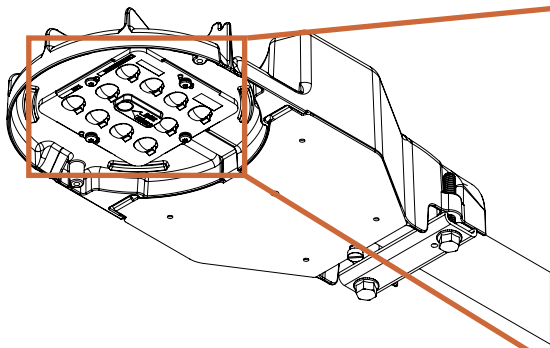

Perimeter Shield Details

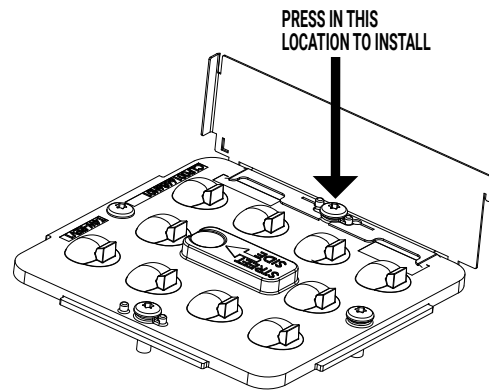
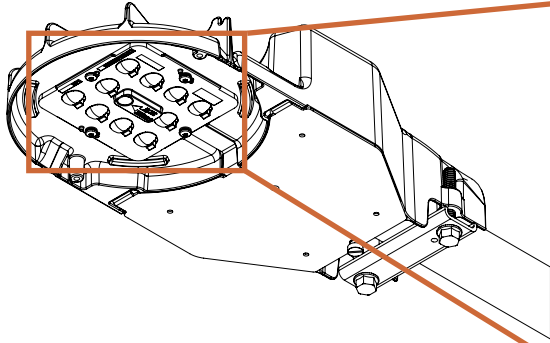

Mounting Details

Optional Wall/Pole Mounting Bracket

Wall Mount / Square Pole Mount

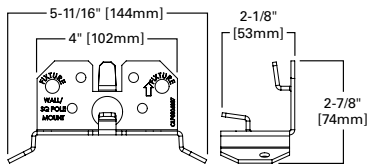

Pole Mount

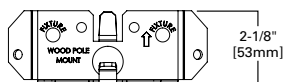

Optional Wood Pole Pipe Arm

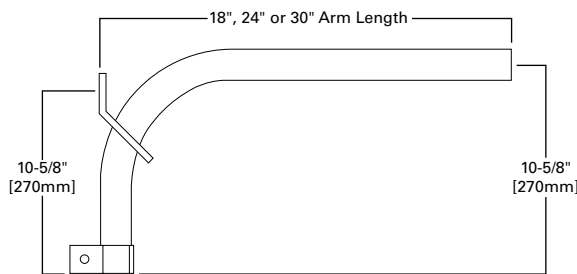

Installation Overview

Quick Instruction Steps:

1. Loosen Mounting Bolts for Pole Clamp
2. Insert Pole Arm Into Fixture
3. Tighten Mounting Bolts on Pole Clamp
4. Open Door by Unscrewing the Door Screw
5. Pull Wires into Housing Through Rear Slot and Wire Appropriately
6. Close fixture Door with Door Screw

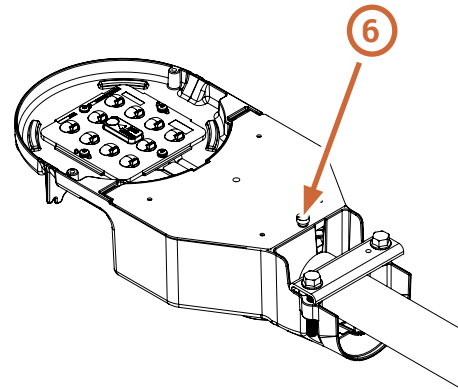
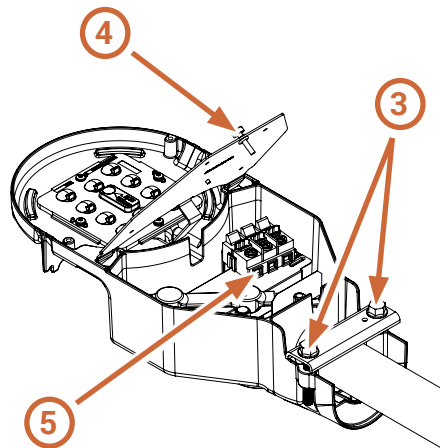
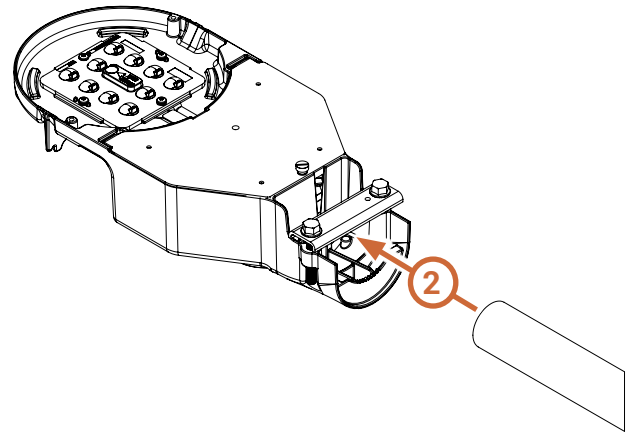
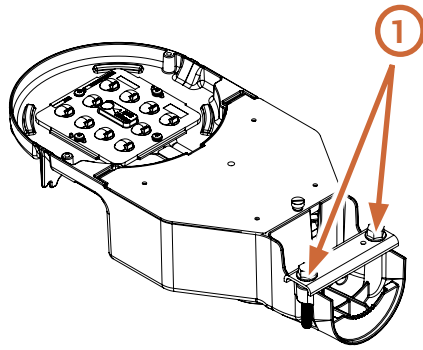

Energy and Performance Data

Nominal Power (Watts)	20	30	40	50
Actual Power (Watts)	23	32	42	48
Wattage Label	20	30	40	50
Input Current @ 120V (A)	0.19	0.27	0.35	0.40
Input Current @ 277V (A)	0.08	0.12	0.15	0.17

70 CRI, 3000K					
T2R	Lumens	3,423	4,477	5,527	6,060
	Lumens per Watt	148	139	131	127
	BUG Rating	B1-U0-G1	B1-U0-G1	B1-U0-G1	B1-U0-G1
T2R w CNR	Lumens	3,319	4,342	5,360	5,876
	Lumens per Watt	143	134	127	123
	BUG Rating	B1 U0 G1	B1 U0 G1	B1 U0 G1	B2 U0 G2
T3	Lumens	3,410	4,460	5,506	6,036
	Lumens per Watt	147	138	131	127
	BUG Rating	B1-U0-G1	B1-U0-G1	B1-U0-G1	B1-U0-G1
T3 w CNR	Lumens	3,307	4,325	5,340	5,854
	Lumens per Watt	143	134	127	123
	BUG Rating	B1-U3-G1	B2-U3-G2	B2-U3-G2	B2-U3-G2
T5R	Lumens	3,493	4,570	5,641	6,185
	Lumens per Watt	151	141	134	130
	BUG Rating	B2-U0-G1	B3-U0-G1	B3-U0-G1	B3-U0-G1
T5R w CNR	Lumens	3,362	4,398	5,429	5,952
	Lumens per Watt	145	136	129	125
	BUG Rating	B2-U3-G1	B2-U3-G2	B3-U3-G2	B3-U3-G2

70 CRI, 4000K					
T2R	Lumens	3,594	4,701	5,804	6,363
	Lumens per Watt	155	146	138	133
	BUG Rating	B1-U0-G1	B1-U0-G1	B1-U0-G1	B2-U0-G2
T2R w CNR	Lumens	3,485	4,559	5,627	6,170
	Lumens per Watt	150	141	134	129
	BUG Rating	B1-U3-G1	B2-U3-G2	B2-U3-G2	B2-U3-G2
T3	Lumens	3,580	4,683	5,781	6,338
	Lumens per Watt	154	145	137	133
	BUG Rating	B1-U0-G1	B1-U0-G1	B1-U0-G1	B1-U0-G1
T3 w CNR	Lumens	3,472	4,542	5,607	6,147
	Lumens per Watt	150	141	133	129
	BUG Rating	B1-U3-G1	B2-U3-G2	B2-U3-G2	B2-U3-G2
T5R	Lumens	3,668	4,798	5,923	6,494
	Lumens per Watt	158	149	141	136
	BUG Rating	B2-U0-G1	B3-U0-G1	B3-U0-G1	B3-U0-G1
T5R w CNR	Lumens	3,530	4,617	5,700	6,250
	Lumens per Watt	152	143	135	131
	BUG Rating	B2-U3-G1	B3-U3-G2	B3-U3-G2	B3-U3-G2

Lumen Maintenance

Ambient Temperature	25,000 hours*	50,000 hours*	60,000 hours*	100,000 hours*	L70*
25°C	98.1%	96.3%	95.6%	92.8%	>102,000
40°C	98.0%	96.1%	95.3%	92.3%	>102,000
50°C	97.8%	95.6%	94.8%	91.4%	>102,000

Note: * Calculations provided in accordance with IES TM-21-11 using the configuration resulting in highest LED temperature.

Lumen Multiplier

Ambient Temperature	Lumen Multiplier
0°C	1.02
10°C	1.01
25°C	1.00
40°C	0.99
50°C	0.97

FADC Settings

FADC Position	Percent of Typical Lumen Output
1	25%
2	48%
3	56%
4	65%
5	75%
6	80%
7	85%
8	90%
9	95%
10	100%

Note: +/-5% typical value

LED Color Multipliers

CRI	CCT			
	2700	3000	4000	5000
70	0.92	0.95	1.00	1.00

Note: * Estimates, refer to IES files for accuracy.

Optical Distributions

