

**HALO LED ICAT HOUSING FOR REMODEL**

Recessed 6" aperture install from below remodeler type housing for use with LED integrated trims or modules. Suitable for 2x8 residential framing or commercial plenum construction, type IC rated and can be used in direct contact with insulation\*. Airtight rating reduces airflow between living spaces and unconditioned areas providing additional energy savings. Use with Halo® LT56, SMD6, RL56, RA56, SLD6 LED integrated trims and the ML56 LED modular recessed lighting system.

<b>Catalog #</b>		<b>Type</b>
<b>Project</b>		
<b>Comments</b>		<b>Date</b>
<b>Prepared by</b>		

**DESIGN FEATURES**

**Housings**

- Single wall precision rolled aluminum housing maintains concentricity
- Mounting flange secures housing to building structure for below the ceiling installation
- Integral gasket achieves ASTM-E283 airtight code compliance without additional gaskets or caulk
- Shipped with overspray protector installed

**Speed Clamps**

- (2) exclusive speed clamps adjusts to accommodate 3/8" to 2" thick ceilings
- Combination hex, slot and Philips drive screws actuate clamps and speed installation
- Clamps can be loosened from below the ceiling for repositioning or splice inspection

**Junction Box**

- Integral compact galvanized steel junction box with 10in<sup>3</sup> internal volume is attached directly to housing to clear obstructions and fit in tight spaces
- Listed for (6) #12 or (8) #14 AWG 90° C splice conductors

- (3) 1/2" conduit pry-outs positioned to allow straight conduit runs
- (2) Slide-N-Side™ non-metallic (NM) wire traps allows wiring outside the box
- Accepts 14-2, 14-3, 12-2, 12-3 U.S. and 14-2, 14-3, 12-2 Canadian NM cable
- Rotatable wiring tray holds wire nuts captive for one-handed wire termination
- (3) 4-port push wire nuts with clear caps are color coded for quick and reliable mains voltage connections
- Junction box is repositionable 90° on plaster frame to avoid obstructions
- Hinged door for easy wire access

**Connector**

- Two-conductor wire mount connector is rated for 120-277V CAUTION – verify LED module input voltage is compatible with the input voltage of the housing. If uncertain, consult a qualified electrician
- cULus listed with Halo® LT56, SMD6, RL56, RA56, SLD6 and ML56 family of LED integrated trims

**Code Compliance**

- Type IC inherently protected, suitable for direct contact to air permeable insulation and cULus listed for damp locations
- Not for use in direct contact with spray foam insulation, consult NEMA LSD57-2013
- Wet location listed in covered ceilings and IP56 certified with select trims
- Airtight per ASTM-E283
- Can be used for State of California Title 24 high efficacy luminaire compliance
- Suitable for use in clothes closets when installed in accordance with the NEC 410.16 spacing requirements
- Contains no mercury or lead and RoHS compliant
- Options to meet Trade Agreements Act requirements

**Warranty**

- Five year limited warranty, consult website for details [www.eaton.com/lighting/Legal](http://www.eaton.com/lighting/Legal)



**E750RICAT**

**6" Recessed Remodeler Housing**

**For Integrated LED Trims and Modules**

**20W Maximum**

**FOR USE IN INSULATED CEILINGS**

**FOR DIRECT CONTACT WITH INSULATION**

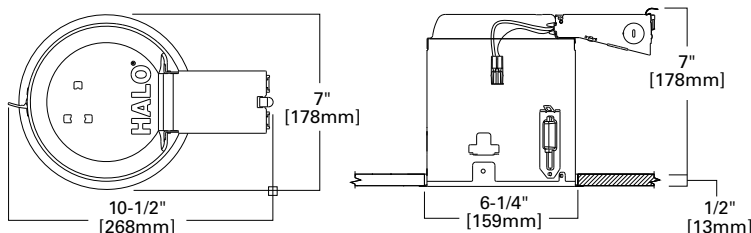

Refer to ENERGY STAR® certified Products List and CEC (T20) Database for compatible Halo LED listings.

**ORDERING INFORMATION - E750RICAT****SAMPLE NUMBER:** E750RICAT - RL560WH6927

A complete luminaire consists of a housing, LED integrated trim or LED module and trim, order separately.

Domestic Preferences <sup>(1)</sup>	Housing	Trims
<b>[Blank]</b> = Standard <b>TAA</b> = Trade Agreements Act	<b>E750RICAT</b> = 6" remodel housing for LED integrated trims or modules	LT56 LA56 SMD6 RA56 RL56 RSQ6 SLD6 ML56

**Notes:** (1) Only product configurations with this designated prefix are built to be compliant with the Trade Agreements Act of 1979 (TAA). Please refer to [DOMESTIC PREFERENCES](#) website for more information. Components shipped separately may be separately analyzed under domestic preference requirements. Accessories sold separately will be separately analyzed under domestic preference requirements. Consult factory for further information.

\*Outdoor rated lamp only (purchase separately)