

**Industrial LED luminaires**  
Exit and Emergency

**Sure-Lites**



# SEL/SELM Indoor/Outdoor

WAREHOUSE / DISTRIBUTION | MANUFACTURING | GYMNASIUMS / MULTI-PURPOSE ROOMS / ATHLETIC CENTER | BIG BOX / RETAIL

SEL



Polycarbonate

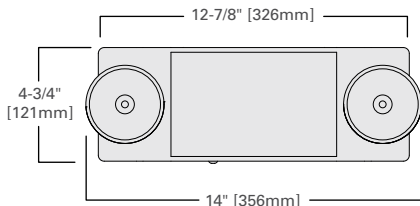

SELM



Metal

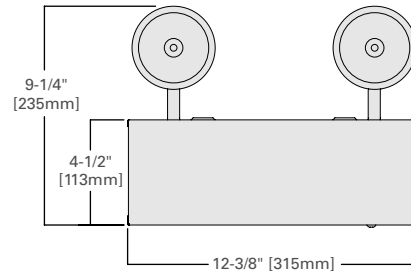

Feature	Benefit
Up to 60 feet of egress coverage	Up to \$300 savings on installation
LED source with Nickel cadmium battery	Up to ten years with no maintenance
Optional remote capacity	Indoor, outdoor design flexibility
Self-diagnostics w/laser test	Reduce labor of NFPA/OSHA testing

Certification/warranty
UL924 damp location
NFPA 101 compliant
NEC/OSHA compliant
5-year product warranty
7-year prorated battery warranty



SEL60, SELM60

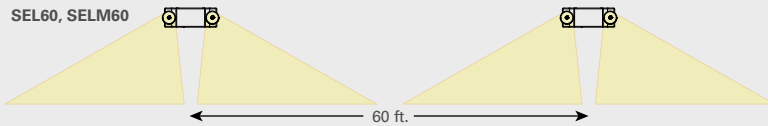

**T20** Certified to California Title 20 Appliance Database



# SELHP100R3 Indoor

WAREHOUSE / DISTRIBUTION | MANUFACTURING | GYMNASIUMS / MULTI-PURPOSE ROOMS / ATHLETIC CENTER | BIG BOX / RETAIL

## SELHP100R3/SELHP100R3SD



High Impact Thermoplastic

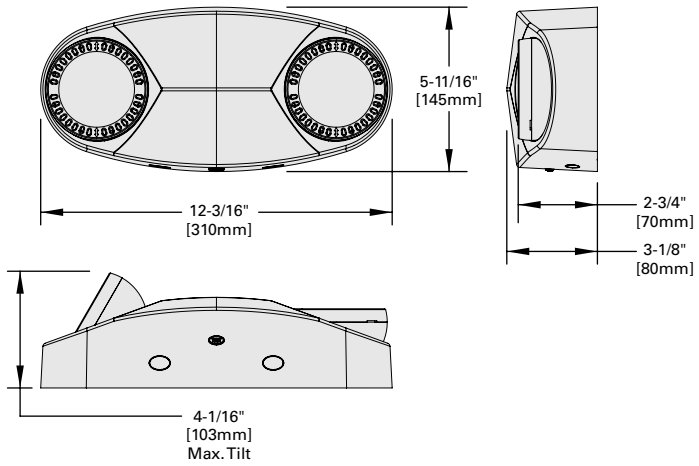

Feature	Benefit
Up to 100 feet of egress coverage	Fewer fixtures required for egress coverage
LED source with LiFePO <sub>4</sub> battery	Peace of mind
3 Watts remote capacity	Indoor, outdoor design flexibility
Self-diagnostics option	Reduce labor of NFPA/OSHA testing

Certification/warranty
UL924 damp location
NFPA 101 compliant
NEC/OSHA compliant
5-year product warranty
5-year battery warranty

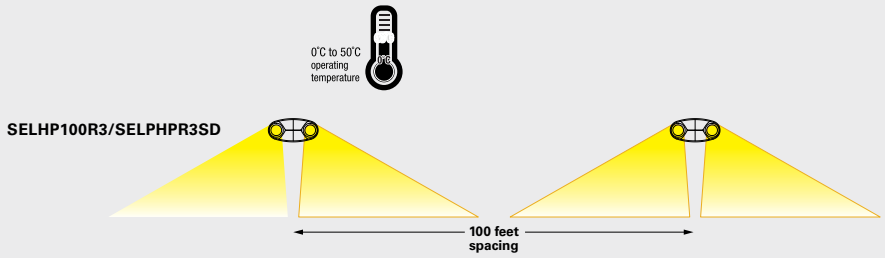

**UL** CERTIFIED **T20** Certified to California Title 20 Appliance Database

damp location Self-diagnostics



# SELW/SELD Outdoor

WAREHOUSE / DISTRIBUTION | MANUFACTURING | GYMNASIUMS / MULTI-PURPOSE ROOMS / ATHLETIC CENTER | BIG BOX / RETAIL

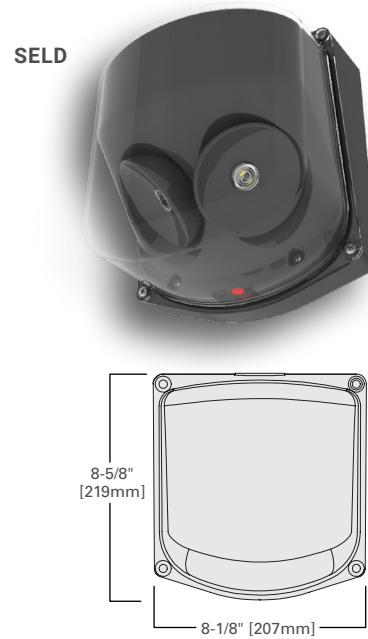
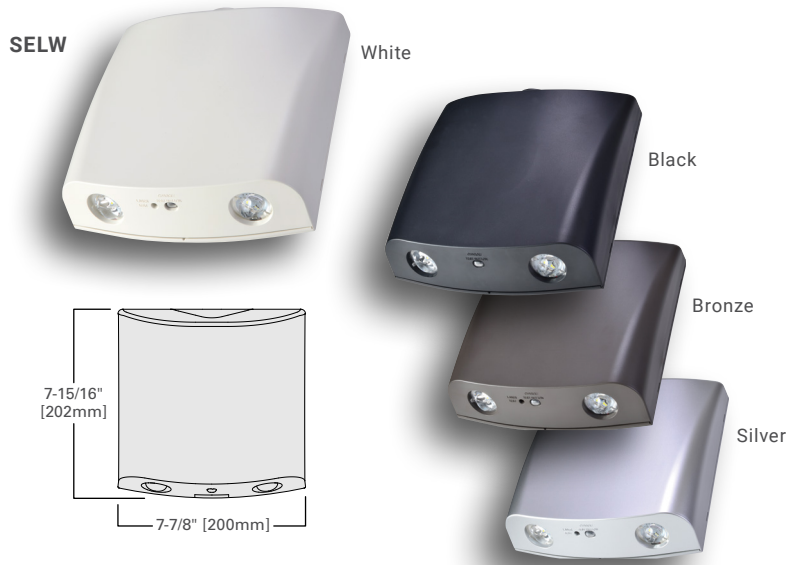

Feature	Benefit
LED source with Nickel cadmium battery	Up to ten years with no maintenance
Forward throw optic	Maximum design flexibility
29 feet spacing	Less fixtures required
Self-diagnostics w/laser test	Reduce labor of NFPA/OSHA testing

Certification/warranty
UL924 wet location
NFPA 101 compliant
NEC/OSHA compliant
5-year product warranty
7-year prorated battery warranty

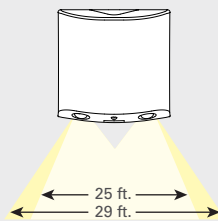

Feature	Benefit
LED source with Nickel cadmium battery	Up to ten years with no maintenance
58 foot spacing	Less fixtures required
Standard self-diagnostics with laser test	Reduce labor of NFPA/OSHA testing
NEMA 4X; IP66; - 30° C to 50° C	Maximum design flexibility

Certification
UL924 wet location
NEMA 4X
NFPA 101 compliant
NEC/OSHA compliant
IP66
NSF
IP66HAZ (class 1, Div 2) option

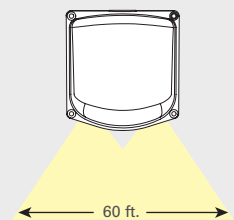

## LPX Exit

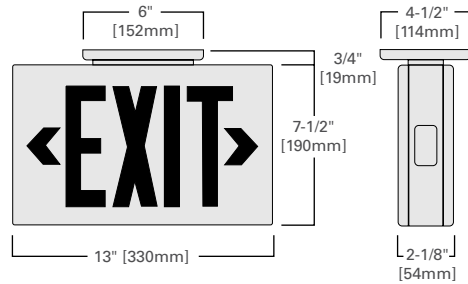

Feature	Benefit
LED source with Nickel cadmium battery	Up to ten years with no maintenance
Field adjustable for red or green	Maximum design flexibility
Optional emergency heads or remote capacity	Less fixtures required
Standard self-diagnostics with laser test	Reduce labor of NFPA/OSHA testing

## Certification/warranty

UL924 damp location
NFPA 101 compliant
NEC/OSHA compliant
5-year product warranty
7-year prorated battery warranty



**T20** Certified to California Title 20 Appliance Database



## LPX LED Combo

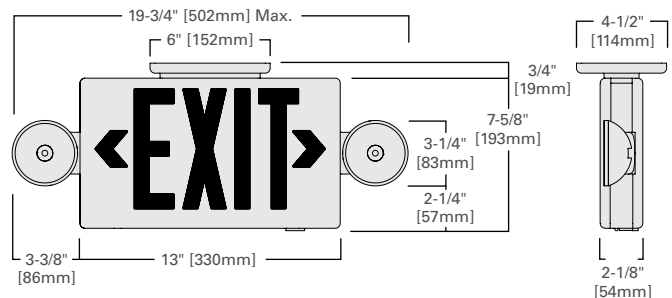

WAREHOUSE / DISTRIBUTION | MANUFACTURING | GYMNASIUMS / MULTI-PURPOSE ROOMS / ATHLETIC CENTER | BIG BOX / RETAIL

UX Exit



SINGLE FACE

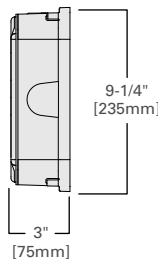
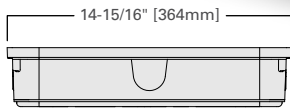

LPWX Exit

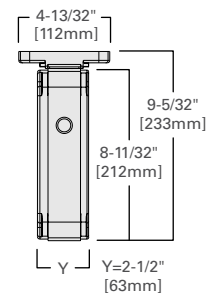
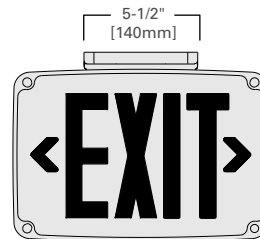
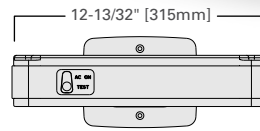

Feature	Benefit
LED source with Nickel cadmium battery	Up to ten years with no maintenance
Field adjustable for red or green	Maximum design flexibility
Standard self-diagnostics with laser test	Reduce labor of NFPA/OSHA testing
NEMA 4X; IP66; - 30° C to 50° C	Maximum design flexibility

Certification/warranty
UL924 wet location
NEMA 4X/IP66
NFPA 101 compliant
NEC/OSHA/NSF compliant
HAZ (class 1, Div 2) rated option
NSF
5-year product warranty, 7-year prorated battery warranty



Feature	Benefit
LED source with Nickel cadmium battery	Up to ten years with no maintenance
UV stabilized polycarbonate housing	Outdoor capable
Standard self-diagnostics with laser test	Reduce labor of NFPA/OSHA testing
Wet location listed; - 30° C to 50° C	Maximum design flexibility

Certification/warranty
UL924 wet location
NFPA 101 compliant
NEC/OSHA compliant
5-year product warranty, 7-year prorated battery warranty



# Why Sure-Lites?

## Product Features

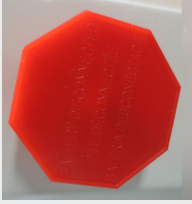

### EZ Key External Battery Disconnect

- Prevents the battery from cycling during the construction phase and ensures a full battery charge for inspection.



### Laser Test

- Enables remote testing by utilizing a laser pointer to simulate AC power loss and engagement of emergency operation.

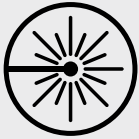

Self-diagnostics

### Self-diagnostics

- Eliminates labor intensive NFPA required monthly testing.



### Red/Green Selectable

- Easy for distribution/no call backs.
- LPX, LPXC, CX and UX series.

LPX Exit



LPXC Exit



CX Exit



UX Exit



**Lighting Brands**

Ametrix  
AtLite  
Corelite  
Ephesus  
Fail-Safe  
HALO  
HALO Commercial  
Invue  
iO  
Iris  
Lumark  
Lumière  
McGraw-Edison  
Metalux  
MWS  
Neo-Ray  
Portfolio  
PrentaLux - 3D Printed Lighting  
RSA  
Shaper  
Streetworks  
Sure-Lites  
Telensa

**Controls Brands**

Greengate  
Fifth Light  
Intelligent Lighting Controls

**Connected Lighting Systems  
and Smart Spaces Platform**

WaveLinx



**Cooper Lighting Solutions**  
1121 Highway 74 South  
Peachtree City, GA 30269  
P: 770-486-4800  
[www.cooperlighting.com](http://www.cooperlighting.com)

Canada Sales  
5925 McLaughlin Road  
Mississauga, Ontario L5R 1B8  
P: 905-501-3000  
F: 905-501-3172

© 2023 Cooper Lighting Solutions  
All Rights Reserved  
Printed in USA  
Publication No. BR505013EN  
August 3, 2023 4:14 PM

Cooper Lighting Solutions is a registered trademark.

All other trademarks are property of their respective owners.

Product availability, specifications, and compliances are subject to change without notice.